

# Pelham Road Land for Sale



## FEATURES:

- 🏡 Size: 1.5 Acres
- 🏡 Uses: Office or Townhome Site  
(See Office & Townhome preliminary drawings)
- 🏡 Utilities: All utilities
- 🏡 Location: Signalized corner/ 1 mile to I-85
- 🏡 Traffic: 19,900 VPD
- 🏡 Frontage: 372' on Pelham Road
- 🏡 Zoning: R-20
- 🏡 Tax Map #: 0533040102000
- 🏡 **Asking Price: \$200,000 /Acre**



See two preliminary site plans for office and townhomes on reverse side. The site plans consider only grading the soil on site.

**Jim Hopple, CCIM [jim@keystonesc.com](mailto:jim@keystonesc.com) Rodger Willoughby [rodger@keystonesc.com](mailto:rodger@keystonesc.com)**

VIEW THIS PROPERTY AT:  
[www.keystonesc.com](http://www.keystonesc.com)

Keystone Commercial Group, LLC  
451 Haywood Rd.  
Greenville, SC 29607

Information contained herein has been obtained from the owners or from other sources deemed reliable. We have no reason to doubt its accuracy, but we regret we cannot guarantee it. All properties subject to change or withdrawal without notice.

**Office: 864.297.4955**  
**Fax: 864.297.6207**

  
**KEYSTONE**  
THE AUTHORITY IN COMMERCIAL REAL ESTATE

# Pelham Road Land for Sale

## OFFICE PRELIMINARY SITE PLAN

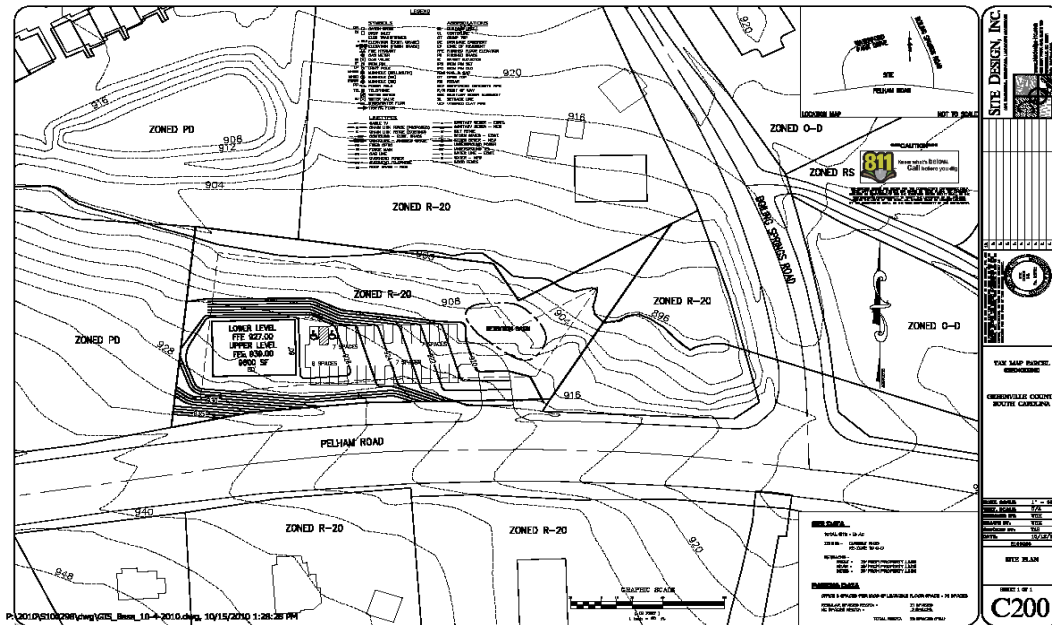

## TOWNHOUSE PRELIMINARY SITE PLAN

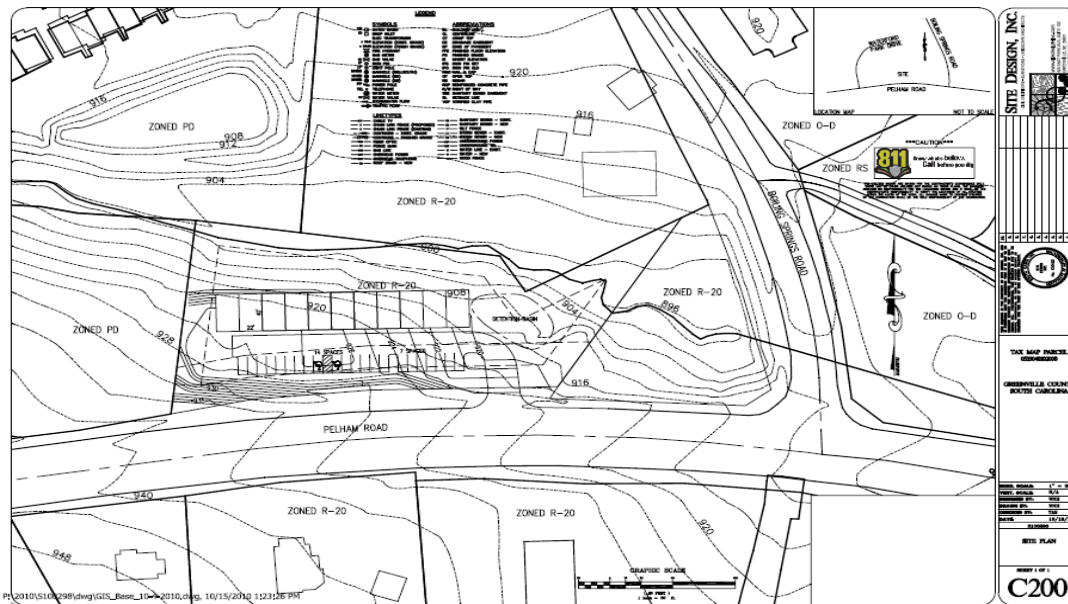

Jim Hopple, CCIM [jim@keystonesc.com](mailto:jim@keystonesc.com) Rodger Willoughby [rodger@keystonesc.com](mailto:rodger@keystonesc.com)

VIEW THIS PROPERTY AT:  
[www.keystonesc.com](http://www.keystonesc.com)

Keystone Commercial Group, LLC  
451 Haywood Rd.  
Greenville, SC 29607

Information contained herein has been obtained from the owners or from other sources deemed reliable. We have no reason to doubt its accuracy, but we regret we cannot guarantee it. All properties subject to change or withdrawal without notice.

Office: 864.297.4955  
Fax: 864.297.6207

**KEYSTONE**  
THE AUTHORITY IN COMMERCIAL REAL ESTATE